

REAR SEAT COMPONENTS

BO2N9-01

2/5/8-Seater model for Hongkong

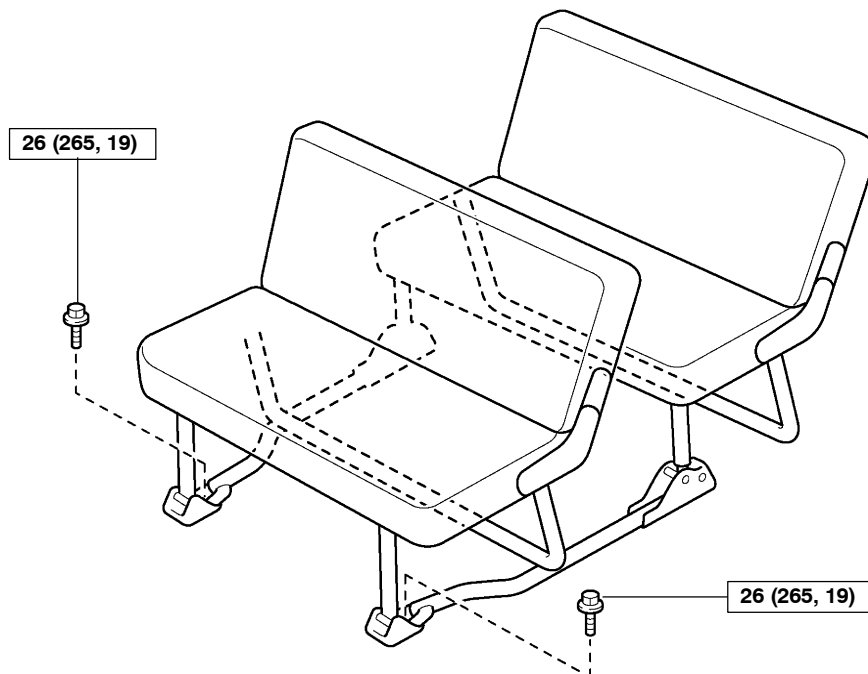

VAN (STD): 3/6-Seater model

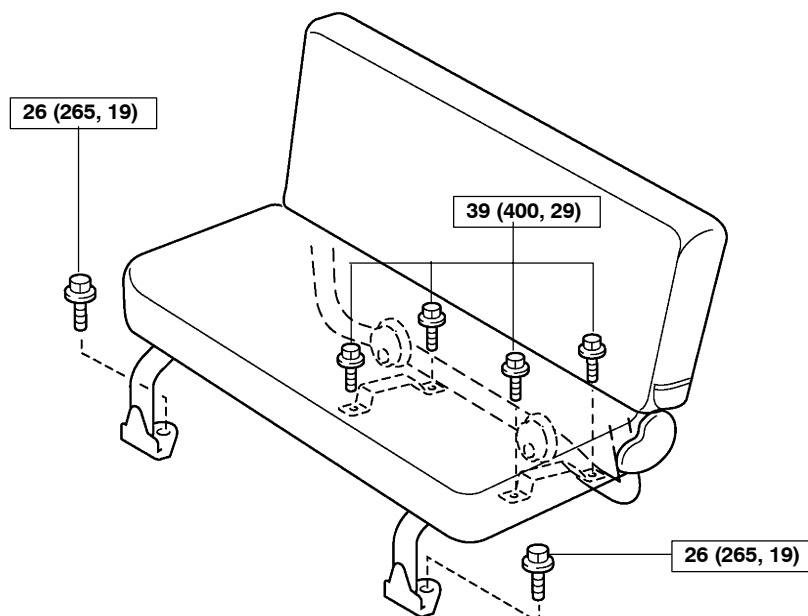

T H12545 H12749 **N·m (kgf·cm, ft·lbf)** : Specified torque

H13147

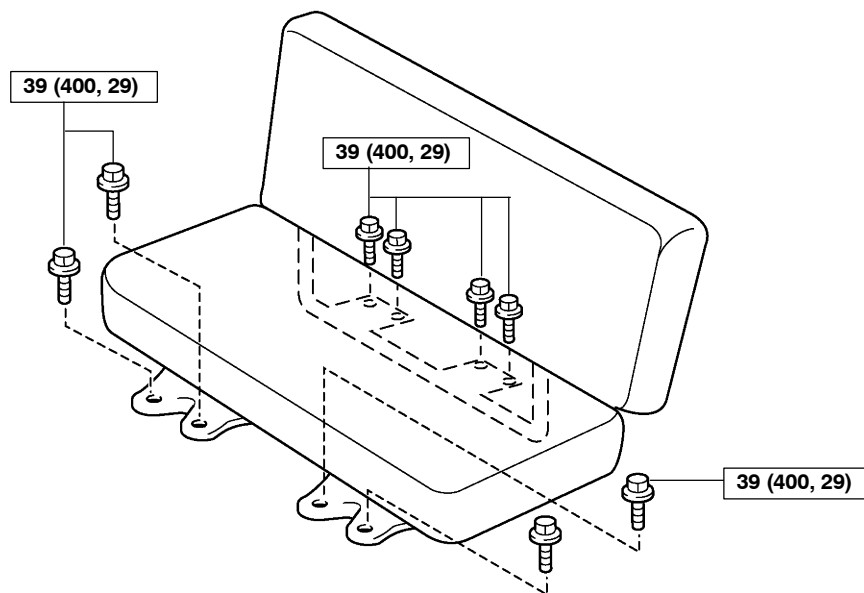
COMMUTER: Rear No. 3 3-Seater model (Fall Forward type)

T

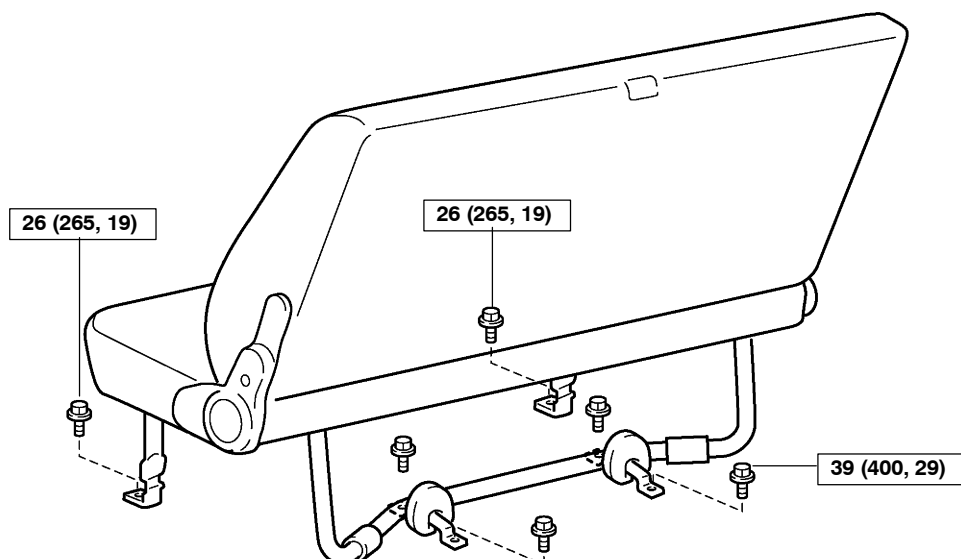
VAN (Super GL):3/6-Seater model

T H12750 H12751 **N·m (kgf·cm, ft·lbf)** : Specified torque

H13148

COMMUTER: 15-Seater model for Australia:

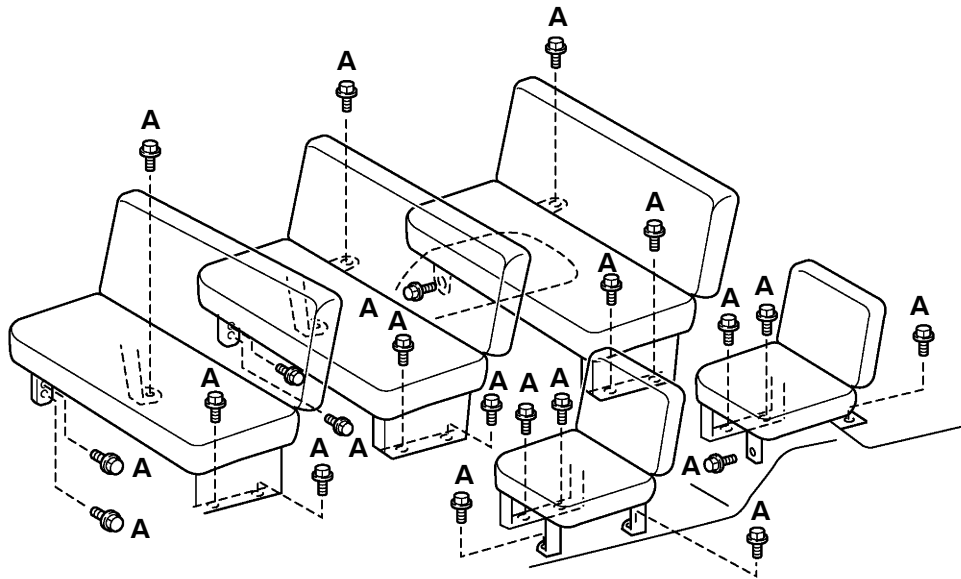

T

Philippine and Russia:

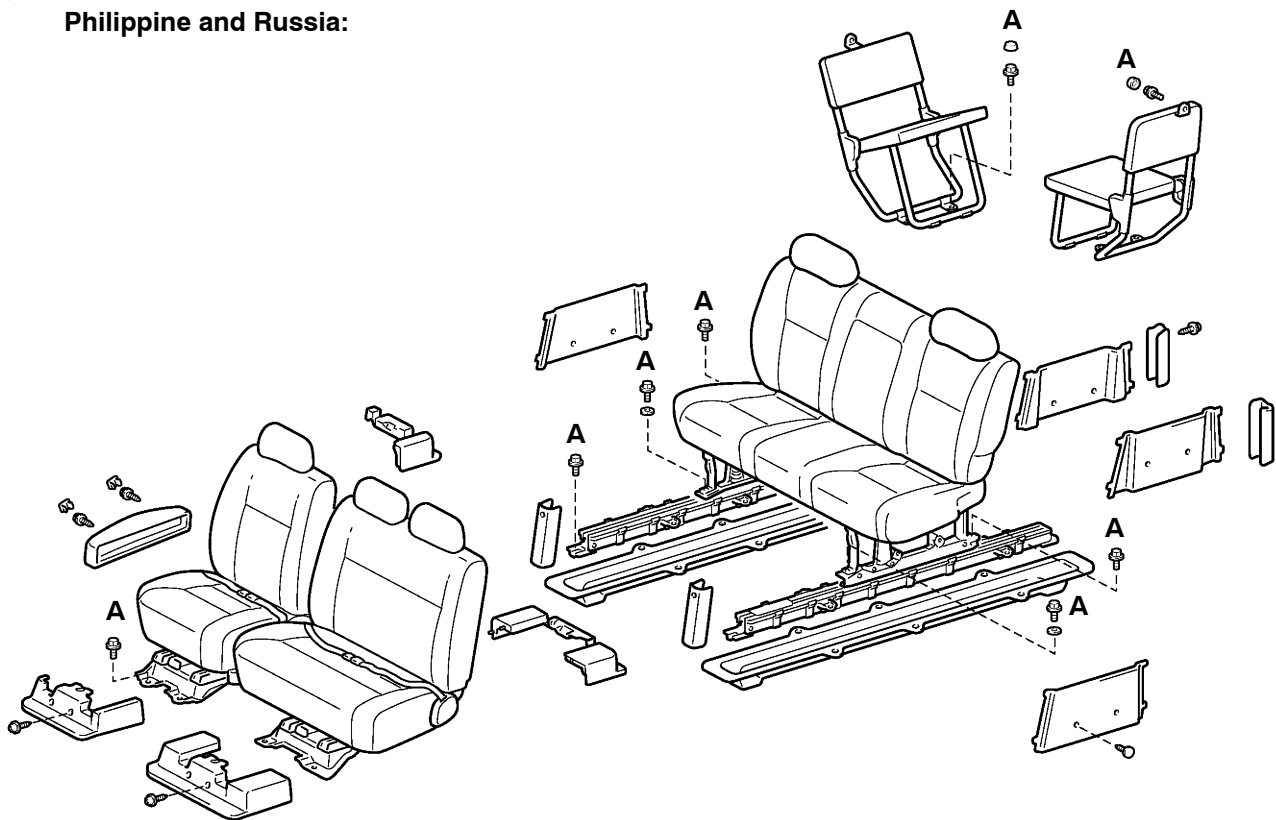

A: 39 (400, 29)

H12752
H12753

N·m (kgf·cm, ft·lbf) : Specified torque

T

H13149